

charnwood 

COVE 1

STOVE DIMENSIONS



The COVE 1 is the smallest in the Cove family. With simple clean lines and a single door, giving an excellent view of the fire, the Cove 1 is ideal for the smaller room. With its fully controllable Quattroflow® air management system it provides around 4kW of heat with superb efficiency. The colour and base options make this a very versatile stove setting new standards in the small stove arena.

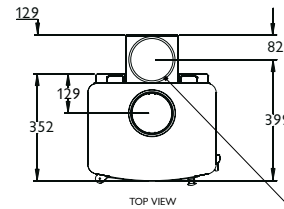

Optional Vertical Rear Flue Adapter

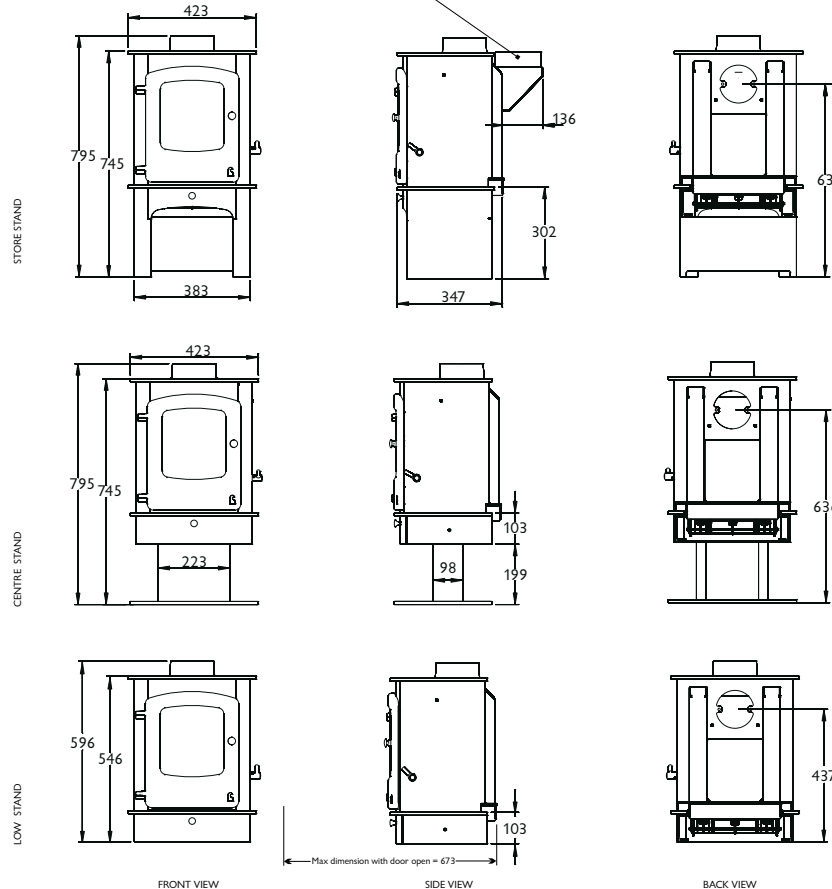

Heat Output to Room

Nominal 4kW (13,600Btu/hr)

Flue Outlet

Top or Rear 125mm (5") diameter

Maximum Log Length

300mm (12 inches)

Weight

Store Stand: 96kg

Centre Stand: 104kg

Low Stand: 89kg

Optional Accessories

Ash Carrier

Vertical Rear Flue Connector

